

## Product Diagram

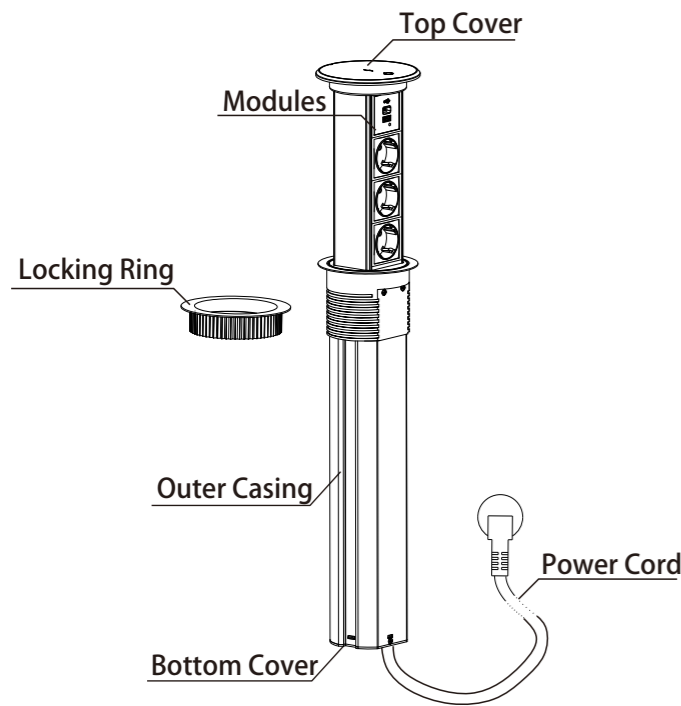

## Safety Guide

1. For indoor use only.
2. When using the wireless charger, do not place metal objects, magnets, magnetic stripe cards, etc. Do not insert foreign objects into the socket.
3. Avoid liquids spills into the outlet.
4. It is strictly forbidden to disassemble the unit.
5. If the product is malfunctioned, immediate electrical maintenance is required by professional.

## Product Features

- Compatible with Type 45 series modules and integrated with 15W wireless charging function.
- IP54 degree of protection in closed status.
- Easy and quick installation.
- With Anti-Trap Safety Mechanism and Anti-Force Mechanism function.

## Requirements for Product Installation

Mounting hole (recommended cut-out dimension:  $\phi 95\text{mm}$ )

## Installation Instructions

### 1. Cut-out opening

Make a 95mm circular grommet hole on the desired surface. Make sure to have enough space below for the unit to fully retract and for the cables to run unhindered from the base of the unit. The recommended space underneath the countertop should be 520mm or more. The required distance between the mounting hole and power supply source should be within 1.5m.

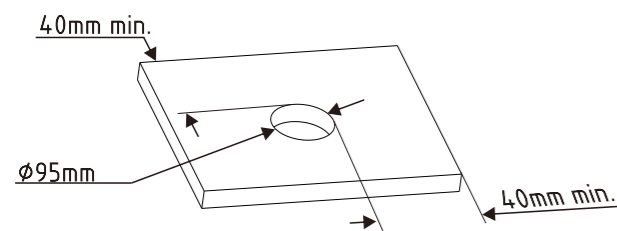

### 2. Mounting the unit

Feed power cord through the grommet hole until the full length of the cable has passed through (Be careful to avoid damage to power cord). Mount the unit into the cut-out and be sure it is fully leveled onto surface.

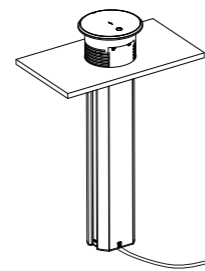

### 3. Secure the product

When in place to the preferred direction, secure the unit from under the desk by screwing back the locking ring. (Please note that when the locking ring is skewed, it will get stuck. It needs to be unscrewed and re-tighten after alignment.)

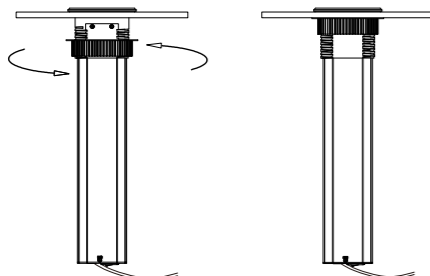

### 4. Connect to power supply

After the installation is complete, plug in the power cord into an applicable power outlet and the unit is ready to use.

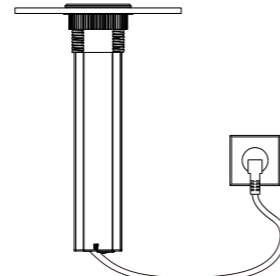

## Operation Instructions

### 1. Initiate the unit

Press and hold the touch switch on the top cover for 3 seconds until the LED light turns blue, to enable the motorized raise/lower function.

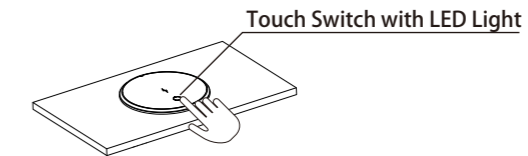

### 2. Intelligent raise operation

- After the initial start process is complete, press the switch again and the unit will raise until fully elevated.
- The unit can be paused during a raise operation by simply pressing on the touch switch.
- If the unit encounters an obstruction during the raise operation, the anti-force function will activate, and the unit will be paused in the current position.
- Once the obstruction has been cleared, the unit can be elevated by pressing on the touch switch again.

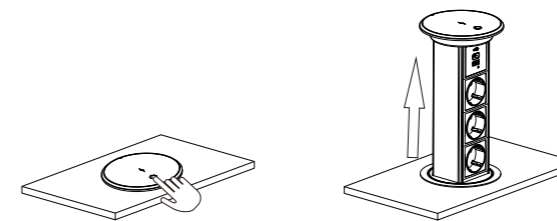

### 3. Intelligent lowering operation

- After the unit is fully elevated, press the touch switch to activate the lowering operation.
- The unit can be paused whilst lowering.
- If the unit is obstructed during lowering operation, the anti-trap safety function will reverse the direction of the travel path, and the unit will raise slightly and pause.

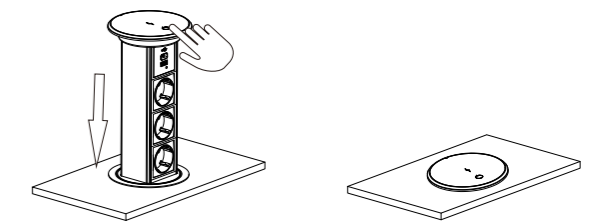

### 4. Wireless charging

- Place the device gently on top of the cover (Avoid accidental contact with touch switch) and charge, compatible with all Qi-enabled devices.
- Make sure the center of the device is aligned over the center of the charging base.
- Ensure that there are no metallic foreign objects on the charging pad.
- Remove the thick device case, if any. It may block the wireless signal.

